



Perfect match

The new Optimer Plug-in Refrigerated Multideck fits smoothly into non-refrigerated merchandise display line-ups. Besides perfectly matching the Linde range of non-refrigerated shop equipment, it combines neatly with the Linde Compilon chiller-freezer and frozen food combinations.

Harmony of style and appearance in merchandising layouts is all the better for business. With its extended product facing area created by the extremely low front panel, the Optimer multideck holds an exceptionally large assortment of merchandise. Its recessed base lets customers step right close to the displays – promoting impulse purchases.

Linde

A complete line of plug-in refrigerated multidecks:

Environmentally friendly design: Use of R 404 A refrigerant and pentane as the insulation foaming agent eliminates ozone depletion potential from construction and operation of the multidecks.

2.31 square metres display area every metre of length. 450 mm deep shelves and 610 mm deep bottom deck result in **maximum productivity per unit floor space.**

Hand-operated night blind as standard. Optional motorized night blind.

Reliable refrigeration temperature is assured even in extreme conditions by **honeycomb air outlet and single or dual air curtain.**

Exceptionally large product facing area. Front opening height of 1360 mm!

Standard **60 mm scanner price marking rail on bottom display deck.** Plastic molding protects from bumps and knocks.

Energy-economizing **electronic controller** optimizes refrigeration system and lowers operating cost.

Digital display of storage temperature builds high customer confidence.



Optimer ..36, Optimer ..46

Highly functional system design

Plinth panel lines up flush with end walls. No breaks or recesses, no dirt traps at junctions with non-refrigerated displays. Basic lengths of refrigerated multidecks are matched to measurements of non-refrigerated units, allowing direct combination or integration.



Leveler feet adjust to obtain exact position and alignment.



Horizontal lighting improved yet again, providing full illumination of top shelf. Combines with **vertical lighting** to enhance long-range visual attraction.

Designed for display flexibility:
Three display shelves - 450 mm deep - fitted as standard. Integrated 40 mm scanner price marking rails. Height and slope easily adjusted. Extra-high front opening of 1360 mm permits adding optional fifth-shelf capacity for a still broader assortment of merchandise.

Also available as **remote version** for connection to external condensing unit or multicompressor refrigeration system.

Panorama end wall glazing, optional to standard part-glazed end walls, enhances visibility of displays from the sides.
Other options:
Vertical lighting and mirrored end walls to visually enlarge stock of merchandise.

Easy cleaning of entire merchandiser.

A cleaning channel under the return air grille separates drip water from cleaning water. It collects dirt and drained liquids so that they can be wiped clear with ease. Extra convenience is provided by cleaning pans available as accessories, which can be rinsed quickly under running water. Smooth surfaces throughout make for effortless upkeep. No air intake grille in the base to gather dirt, no bother with superfluous trims and covers.



Wide range of options

Illuminated display header available for Length 10, 13 and 19 multidecks.

Internal mirrors 326 mm deep.

Display shelf dividers of acrylic glass.

Display shelf dividers of wire type.

40 mm scanner price marking rail with 25 mm high product stop.

Bottom display deck dividers usable also together with wire racks.

Adjustable-height wire rack for bottom display deck, wire or solid metal front fence.

Set of cleaning pans placed under return air grille to speed up and simplify routine cleaning.

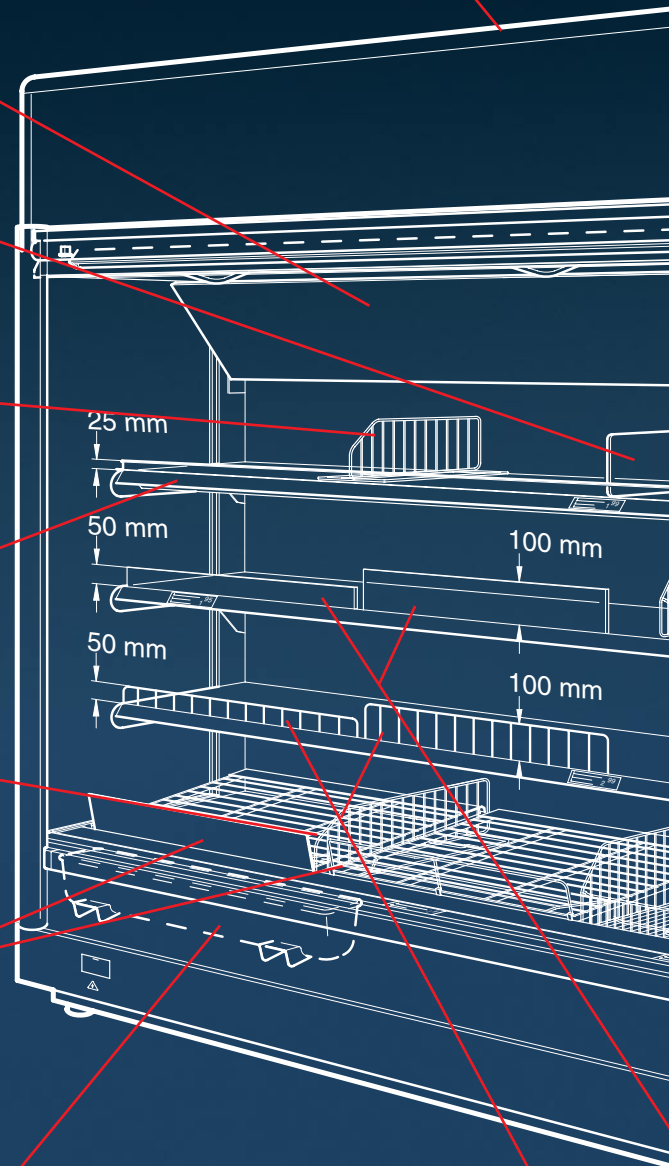

Ex-works options not illustrated

- Gravity-chute display shelves for beverages.
- Display hooks for convenience commodities.
- Kickplate fitted with floor seal strip.
- Caster base for Length 10 and 13 to special order.
- Remote version for operation on external refrigeration system.
- Joint trim in same color finish for back-to-back siting.
- Colored canopy or front trim panel.
- Additional display shelf to stock extra large assortment.
- Sound-absorbing package for extra quiet operation.
- 40 mm scanner price marking rails available in seven other colors to special order.

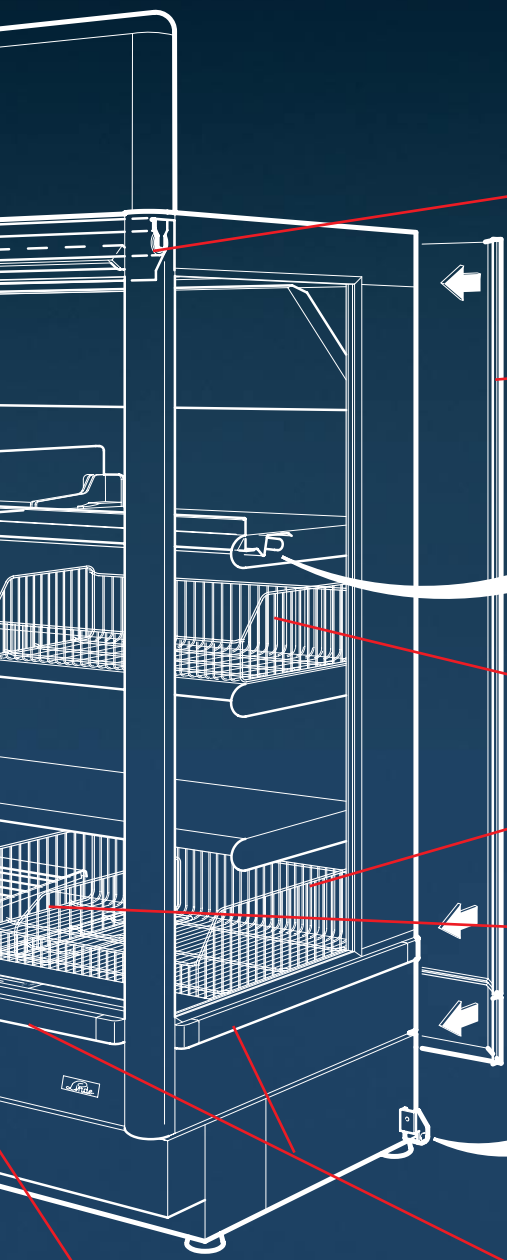

Vertical lighting for both end wall panels.

Night blind hand-operated (as standard) or motorized in conjunction with lighting switch.

Rear wall panel in same color finish, required for open siting.

Auxiliary shelf lighting.

Fruit and vegetable baskets, complete set for one display shelf or bottom display deck.

Fruit and vegetable basket dividers.

Siting aid mounted on both rear leveler feet, for extra ease of integrating into non-refrigerated shop equipment layouts.

Front and end wall bumpers, colored finishes to special order.

Acrylic glass front fence product stop
50 or 100 mm high.

Wire front fence product stop
50 or 100 mm high.

Accessories, fittings and applications



Illuminated display header available for Length 10, 13 and 19 multidecks.



Rear wall panel in same color finish for open siting.



Night blind, hand-operated (as standard) or motorized



Panorama end wall with full-size insulating glass and vertical lighting; ex-works option.

Panorama end wall, full-size insulating glass; ex-works option.

Standard end wall, part-glazed.

Non-glazed end walls, internally mirrored; ex-works option.



Optimer multideck version for fruit and vegetable display.



Optimer convenience food version with five shelves for extra large display assortment.



Optimer multideck version for self-service meat merchandising.



Floral displays are a highly demanding application. Linde recommends the Optimer .46 multideck fitted with special hollow-core display shelves and a set of cleaning pans under the return air grille. Optimer 2546 illustrated.

Standard color finishes available for multideck and canopy and front trim panels

Interior fittings in black or aluminium-white finish for special highlighting of merchandise.

Colors shown here are examples of the 50 finishes available in the Compact Line of refrigerated merchandisers.

Aluminium-white
RAL 9006



Black
RAL 9005



Fire-red
RAL 3000



Light grey
RAL 7035



Light ivory
RAL 1015



Light blue
RAL 5012



Yellow-green
RAL 6018



Daffodil-yellow
RAL 1007



Lemon-yellow
NCS 0070-G90Y



Sky-blue
RAL 5015



Ultramarine
RAL 5002



Sapphire-blue
RAL 5003



White
NCS 0501-B58G



Herlit grey
NCS 3500



Duran grey
NCS 6500



Optimer Refrigerated Multideck – 5 basic lengths



Optimer 0946*
(Length 885 mm)

Optimer 1046
Optimer 1036
(Length 990 mm)

Optimer 1346
Optimer 1336
(Length 1250 mm)

Optimer 1946
Optimer 1936
(Length 1875 mm)

Optimer 2546
Optimer 2536
(Length 2500 mm)

* Optionally available with shorter base length of 840 mm.

Measurements

Standard Version with part-glazed end walls

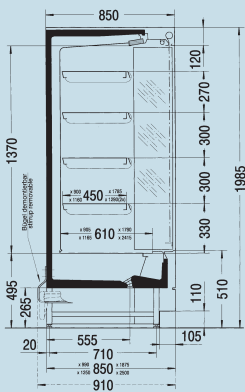

High-End Version with panorama end wall glazing

Version 1
Sandwiches

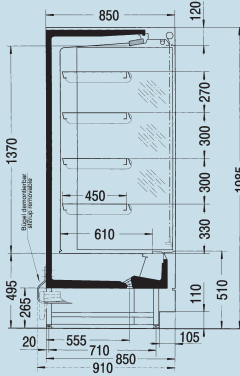

Version 2
Fruit and Vegetables

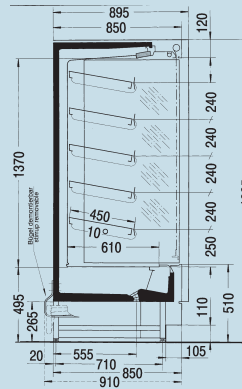

Version 3
Self-Service Meat

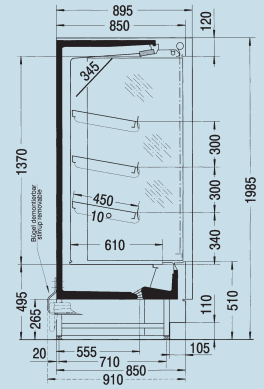
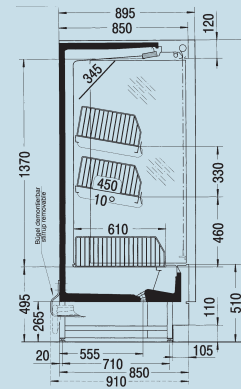

Versions 1, 2 and 3 with vertical lighting

Rear stirrups or factory-fitted wall spacers can readily be detached and refitted for bringing in.

Data **Optimer		0946	1046	1036	1346	1336	1946	1936	2546	2536
Length over end walls	[mm]	885	990		1250		1875		2500	
Display area	[m ²]	1.93	2.20		2.82		4.33		5.83	
Storage temperature	[°C]	0 to 2	0 to 2	2 to 8	0 to 2	2 to 8	0 to 2	2 to 8	0 to 2	2 to 8
Temperature Class		25 °C/60 % RH		30 °C/55 % RH	30 °C/55 % RH		30 °C/55 % RH	30 °C/55 % RH	30 °C/55 % RH	
Power supply	[V]/[Hz]	230 / 50		230 / 50	230 / 50		230 / 50	230 / 50	230 / 50	
Fuse rating	[A]	13		13	16		16	16	16	
Refrigerant						R 404 A				

** Standard Version

Linde Kältetechnik GmbH & Co. KG
Sürther Hauptstrasse 173
50999 Cologne
Germany
Phone +49-22 36-6 01-01
Telefax +49-22 36-6 01-1 54
www.linde-refrigeration.com
info@linde-kt.de
compact.linde@linde-kt.de

